

+OWNERSHIP 173193 2024 1/04/2024  
 COWARD KAWANNA LAKEISHA  
 6923 CROSS CREEK DR  
 GRIFTON NC 28530  
 DEED: 1841 643

PROPERTY DESCRIPTION  
 URBAN EST 9 E  
 L80900/16  
 3526 URBAN ESTATES DR

TAX SUBDIVISIONS  
 CONTENTNEA NECK  
 COUNTY/GRIFTON HUGO FIRE

MAP NUMBER 456801151424  
 RECORD NUMBER: 999  
 ROUTE 1094000  
 LISTER: LNLGLISH 5012023  
 REVIEW:

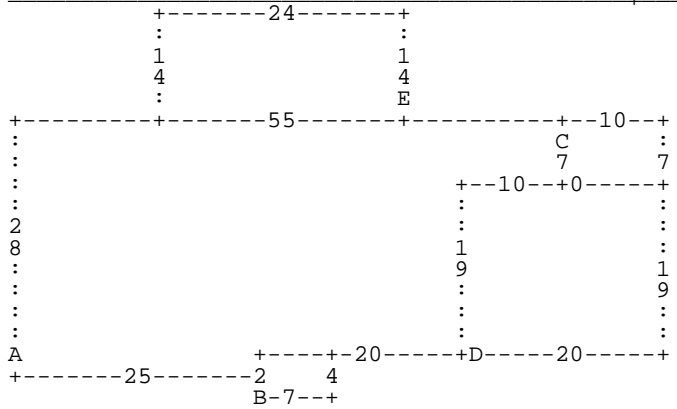

TOPO	STREET	UTILITY	ZONING	ACRES	NBHD
				.510	0103

NOTES:

#	LAND CLASS	SIZE	*RATE	*SIZ%	*DPT%	*ADJ%	=LND-VALUE
1	1L LOT	1.15LT	5000		1.00	1.00	5750

LAND VALUE:

#	OTHER FEAT	SIZE	BASERATE	*SIZ%	ADJRATE*	UNITS	*OGR%	-COND%	=OFB-VALU
60	21CBLDGS-NV	1*				1	1.00	.01	
61	41CMH-HK-UP	*	2000.00			1	1.00		2000

OTHER VALUE:

FNDATION	XTRFNISH	HEAT&AIR	ROOFMTRL	SIZE/OTY	DPRT:DEPR	- RESIDENTIAL	- STD
BRICK	BRICK	HEATPUMP	COMPSHNG	1.00STHT			
CONIWALL				3 BDRM	1.00LFUF		

RES - IMP C AYB 1977 EYB  
 DIMENSIONS: A-DU28DR55DD7DL10DD19DL20DD2DL25 B-MR25DD2DR7DU4DL7DD2 C-MR25MR30MU28DD7DR10DU7DL10 D-MU28MR55ML  
 10MD26DR20DU19DL20DD19 E-MU2MR45MU19MR10MU7ML16DU14DL24DD14DR24

#	STRUCTURE	SKTCH-SF*	STHT	BASERATE	*SIZE%	*WLHT%	= ADJRATE*	AREA*	*STY=	COST	OG%	OG RCN	-DEPR%	-CND%=	FMV
A	01 SINGLE F	1290	1.00	79.84	.8714		69.572	1290	1.00	89747					
	0110 HEATPUMP			2.00			2.000	1290		2580					
	0103 BRICK			3.00			3.000	1290		3870					
	1.00 FULL BTH			3000.00			3000.000			3000					
	1.00 FP			3000.00			3000.000			3000					
	1.00 HALF BTH			1800.00			1800.000			1800					
B	83 STOOP	28	1.00	14.32	.7695		11.019	28	1.00	308					
C	78 UTILITYB	70	1.00	28.50	1.0000		28.500	70	1.00	1995					
D	79 CARPORT-	380	1.00	17.50	1.0000		17.500	380	1.00	6650					
E	84 WOOD DEC	336	1.00	23.27	.4936		11.486	336	1.00	3859					
			HSF:	1290.00			%COMP: 100			RPCN: 116809	1.00	116809	-.40-	.10=	63078
							STRUCTURE VALUE:			90.54	OGRCN/HSF	48.89	FMV/HSF		63078

VALUATION	VALUE	PREV-VAL.	P-N%	SALE	S-N%	TOTAL VALUE
LAND	5750	5750	100%	WD		11274LV/AC
OTHERFEAT	2000	2000	100%	10192018		
STRUCTURE	63078	63078	100%	1841-643		TV/HSF
TOTAL	70828	70828	100%	74000	0095%	SP/HSF

APPRAISED-VALUE: 70828