

+OWNERSHIP 1006764      2024 1/04/2024  
 PARKS MUSTAFA WALI  
 PARKS DEIDRA CHANEL  
 2100 WESTWOOD DR  
 KINSTON NC 28504  
 DEED: 1836 285

PROPERTY DESCRIPTION  
 2100 WESTWOOD DRIVE  
 2100 WESTWOOD DR  
 2100 WESTWOOD DR

TAX SUBDIVISIONS  
 FALLING CREEK  
 COUNTY/CITY OF KINSTON

MAP NUMBER      CARD NO  
 450603409145      1  
 RECORD NUMBER: 1865  
 ROUTE 3009000  
 LISTER: LNLGLISH 5012023  
 REVIEW:

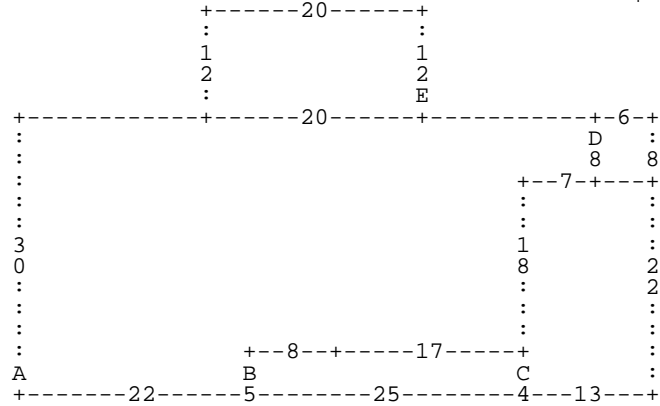

TOPO	STREET	UTILITY	ZONING	.350 ACRES		NBHD	
			RA12			0012	
NOTES:							
#	LAND CLASS	SIZE	* RATE	*SIZ%*	DPT%*	ADJ%*	=LND-VALUE
1	2D LOT	1.00LT	15000		1.00	1.00	15000
LAND VALUE:							15000
#	OTHER FEAT	SIZE	BASERATE*	SIZ%*	ADJRATE*	UNITS	*OGR%-COND%=OFB-VALU
2	27 STGBLD	*	10.00			1	500
OTHER VALUE:							500
FNDATION	XTRFNISH	HEAT&AIR	ROOFMTRL	SIZE/OTY	DPRT:DEPR - RESIDENTIAL - STD		
BRICK	BRICK	HEATPUMP	COMP SHNG	1.00STHT			
CONIWALL		HEATPUMP		'WALL			
				3 BDRM			

RES - IMP      C      AYB 1972 EYB 1987  
 DIMENSIONS: A-DU30DR54DD8DL7DD18DL17DU1DL8DD5DL22 B-MR22DU5DR8DD1DR17DD4DL25 C-MR22MR25DU22DR13DD22DL13 D-MR  
 47MR7MU30DD8DR6DU8DL6 E-MU30MR54ML16DU12DL20DD12DR20

#	STRUCTURE	SKTCH-SF*	STHT	BASERATE	*SIZE%	*WLHT%*	ADJRATE*	AREA*	%STY=	COST	OQ%	OG RCN	-DEPR%-CND%*	FMV
A	01 SINGLE F	1358	1.00	79.84	.8394		67.017	1358	1.00	91009				
	0110 HEATPUMP			2.00			2.000	1358		2716				
	0103 BRICK			3.00			3.000	1358		4074				
	2.00 FULL BTH			3000.00			3000.000			6000				
B	81 PORCH	108	1.00	31.91	.7271		23.201	108	1.00	2505				
C	79 CARPORT-	286	1.00	17.50	1.0000		17.500	286	1.00	5005				
D	78 UTILITYB	48	1.00	28.50	1.0000		28.500	48	1.00	1368				
E	05 SOLARIUM	240	1.00	64.13	.5442		34.899	240	1.00	8375				
	0510 HEATPUMP			2.00			2.000	240		480				
				HSF:	1598.00	%COMP: 100	RPCN:	121532	1.00	121532	-.30-	=	72312	
				MKT	85.00	STRUCTURE VALUE:	76.05	OGRCN/HSF		45.25	FMV/HSF		72312	

VALUATION	VALUE	PREV-VAL.	P-N%	SALE	S-N%	TOTAL VALUE
LAND	15000	15000	100%	WD		42857LV/AC
OTHERFEAT	500	500	100%	08072018		
STRUCTURE	72312	72312	100%	1836-285		TV/HSF
TOTAL	87812	87812	100%	93000	0094%	SP/HSF
						APPRAISED-VALUE: 87812