

+OWNERSHIP 39154  
 WISE DAVID S SR  
 WISE ELIZABETH P  
 1004 BRENTWOOD DRIVE  
 KINSTON NC 28501  
 DEED: 663 34

2024 1/04/2024

PROPERTY DESCRIPTION  
 1004 BRENTWOOD DRIVE  
 1004 BRENTWOOD DR

TAX SUBDIVISIONS  
 KINSTON  
 COUNTY/CITY OF KINSTON

MAP NUMBER  
 452612850675  
 RECORD NUMBER: 14779  
 ROUTE 12096000  
 LISTER: LNLGLISH 5012023  
 REVIEW:

CARD NO  
 1

1004 BRENTWOOD DR

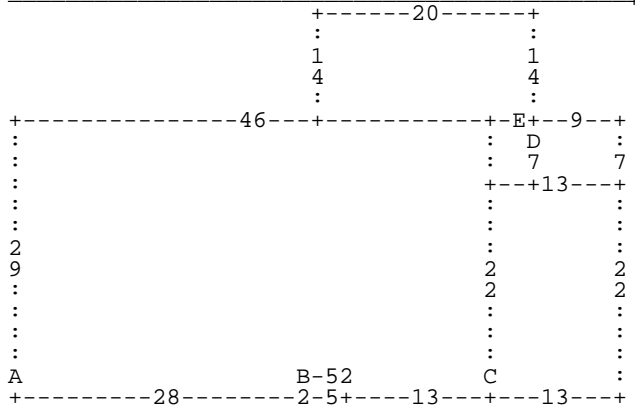

TOPO	STREET	UTILITY	ZONING	ACRES	NBHD
			RA6	.220	0229

#	LAND CLASS	SIZE	*RATE	*SIZ%	*DPT%	*ADJ%	=LND-VALUE
1	LV LOT	1.00LT	10000		1.00	1.00	10000

#	OTHER FEAT	SIZE	BASERATE	*SIZ%	ADJRATE*	UNITS	*OGR%	-COND%	=OFB-VALU
60	27CSTGBLD	1* 1	10.00			1	1.00	.01	500

FNDATION	XTRFNISH	HEAT&AIR	ROOFMTRL	SIZE/OTY	DPRT:DEPR - RESIDENTIAL - STD
BRICK	BRICK	HEATPUMP	COMP SHNG	1.00STHT	
CONIWALL	BRICK	HEATPUMP		'WALL	
				3 BDRM	

RES - IMP D AYB 1971 EYB 1982  
 DIMENSIONS: A-DU29DR46DD29DL13DU2DL5DD2DL28 B-MR28DU2DR5DD2DL5 C-MR28MR18DU22DR13DD22DL13 D-MR46MR4MU29DD7DR  
 9DU7DL9 E-MU29MR50DL20DU14DR20DD14

#	STRUCTURE	SKTCH-SF*	STHT	BASERATE	*SIZE%	*WLHT%	ADJRATE*	AREA*	*STY=	COST	OG%	OG RCN	-DEPR%	-CND%=-	FMV
A	01 SINGLE F	1324	1.00	79.84	.8350		66.666	1324	1.00	88265					
	0110 HEATPUMP			2.00			2.000	1324		2648					
	0103 BRICK			3.00			3.000	1324		3972					
	1.00 FULL BTH			3000.00			3000.000			3000					
	1.00 HALF BTH			1800.00			1800.000			1800					
B	81 PORCH	10	1.00	31.91	1.0000		31.910	10	1.00	319					
C	02 SEMI-FIN	286	1.00	34.97	.7304		25.542	286	1.00	7305					
	0210 HEATPUMP			2.00			2.000	286		572					
	0203 BRICK			3.00			3.000	286		858					
D	78 UTILITYB	63	1.00	28.50	1.0000		28.500	63	1.00	1795					
E	84 WOOD DEC	280	1.00	23.27	.4943		11.502	280	1.00	3220					
				HSF:	1610.00		%COMP: 100	RPCN:		113754	.86	97828	-.35-	=	56276
				MKT	88.50		STRUCTURE VALUE:	60.76	QGRCN/HSF			34.95	FMV/HSF		56276

VALUATION	VALUE	PREV-VAL.	P-N%	SALE	S-N%	TOTAL VALUE
LAND	10000	10000	100%	UNK		45454LV/AC
OTHERFEAT	500	500	100%	12311972		
STRUCTURE	56276	56276	100%	0663 -0034		TV/HSF
TOTAL	66776	66776	100%		0000%	SP/HSF

APPRAISED-VALUE: 66776